

SB60X30-8TD-XH-SC

60 X 30 SOLID SURFACE SHOWER BASE WITH RH OR LH TRENCH DRAIN IMI SOLIDCAST™

Exterior Dimensions: 59¾" W x 30"D
Note: Base dimensions may vary +/- ¼"



COLOR & TRIM OPTIONS

| Standard Color | Code |
|----------------|------|
| White | SW |

Material to be crated and stacked on pallets.



FEATURES

- **Shower size:** 59 ¾" x 30"
- **Curb size:** 3" x 2 ¾"
- **Construction:** * Single-piece cast engineered stone receptors
 - * Pre-leveled
 - * Rests on the subfloor
 - * Non-porous
 - * No gel-coat or other top-coat finishes included
 - * Contains minimum 60% natural stone material
 - * Contains premium grade solid cast resin, NPG-isophthalic (ISO), UV inhibited acrylic based polyester resin
- **Resistant to:** * Bacteria
 - * Mold and mildew
 - * Stains (easy to clean)
- **Flange:** * Integrated

STANDARDS AND RATINGS

- Typical CSI Code: 22 42 23 (Div 22)
- ANSI
- MAS Certified Green
- Slip-resistance
- Breaking strength: 250 lbs. minimum

*See terms and conditions for details.

SB60X30-8TD-XH-SC

60 X 30 SOLID SURFACE SHOWER BASE WITH RH OR LH TRENCH DRAIN IMI
SOLIDCAST™

Note: Base dimensions may vary +/- 1/4"

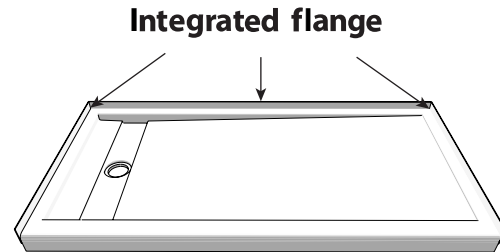
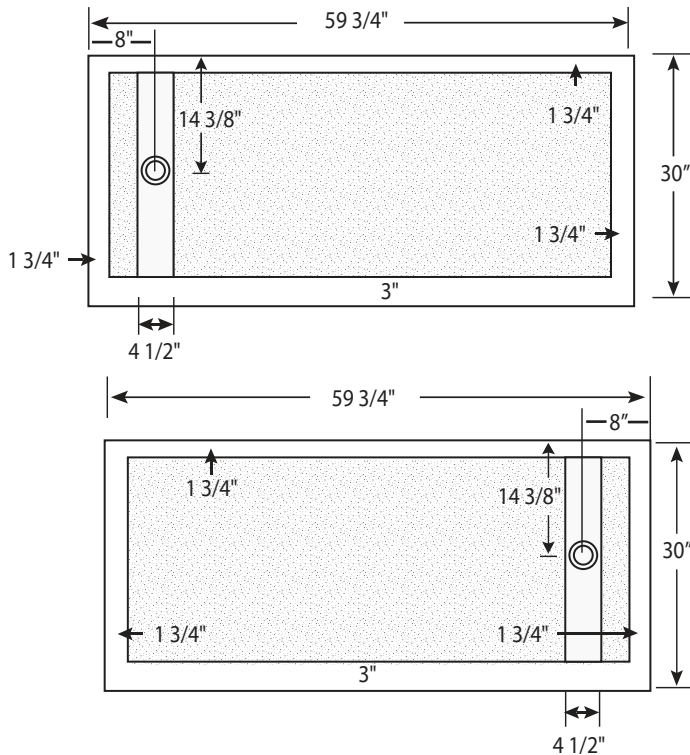

Side View of Curb

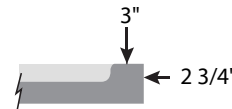

Drain Details: (U.S.)

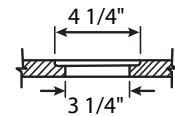

Integrated Flange Details: (U.S.)

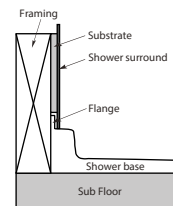

Integrated Flange Details: Fire Rated Walls (U.S.)

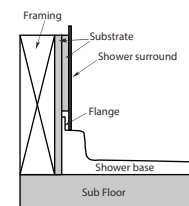

NOTE: 2% sloped towards the drain**



FEATURES Dimensional Tolerance $\pm 1/4"$. Dimensions needed for site preparation should be measured from the unit. American Bath Group assumes no responsibility for preparatory work.

| Type and Model # | Material | Shower Base | Pieces |
|--------------------------------|------------|---------------------------|--------|
| Shower Base #SB60x30-8TD-xH-SC | Solid Cast | Anti-Slip/Textured Finish | 1 |

DIMENSIONS

| Specifications | inches |
|--------------------|--------|
| Shower Base Depth: | 30 |
| Shower Base Width: | 59 3/4 |
| Curb Height: | 2 3/4 |
| Curb Width: | 3 |

SUGGESTED DRAINS

| Image | Description |
|---|---|
|  | Solvent Weld type fitting similar to Oatey Part No. 42097 |
|  | Compression type "No-Caulk" fitting similar to Oatey Part No. 42099 |